

## MEDAMEDA

ZMM678

Miscelatore monocomando lavabo incasso. / Built-in single lever basin mixer.



Miscelatore monocomando lavabo incasso con aeratore. Lunghezza bocca 215 mm.  
Water Saving - portata d'acqua uguale o inferiore a 6 l/min.

Built-in single lever basin mixer with aerator. Spout projecton L 215 mm.  
Water Saving - water flow rate of 6 l/min or less.

R99499

Parte incasso. / Built-in part.







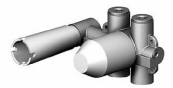





R99815

Parte incasso. / Built-in part.



## Finiture / Finishes

 Cromo / Chrome	 C3 Nickel Spazzolato / Brushed Nickel	 C8 Nickel Lucido / Polished Nickel	 C40 Oro / Gold	 C41 Oro spazzolato / Brushed Gold	 C50 Metal Black / Metal Black	 C51 Metal Black spazzolato / Brushed Metal Black
 N1 Nero Opaco Goffrato / Embossed Matt Black	 P31 Brushed PVD British gold / Brushed PVD British gold	 P81 Brushed total black PVD / Brushed total black PVD				

## MEDAMEDA

ZMM678

Disegno Complessivo / Overall Drawing

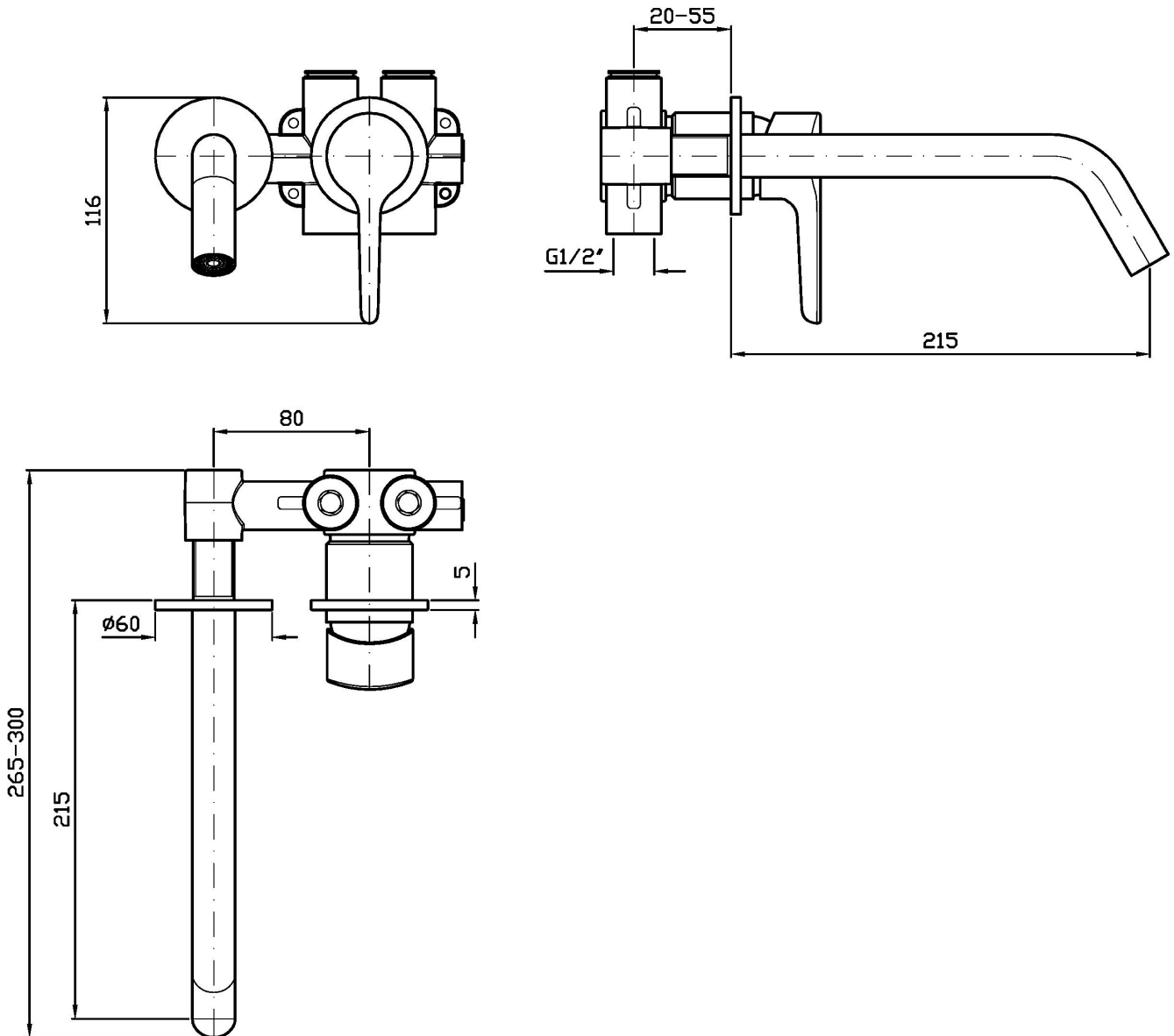

Note / Notes

## MEDAMEDA

ZMM678

Esplosi / Exploded

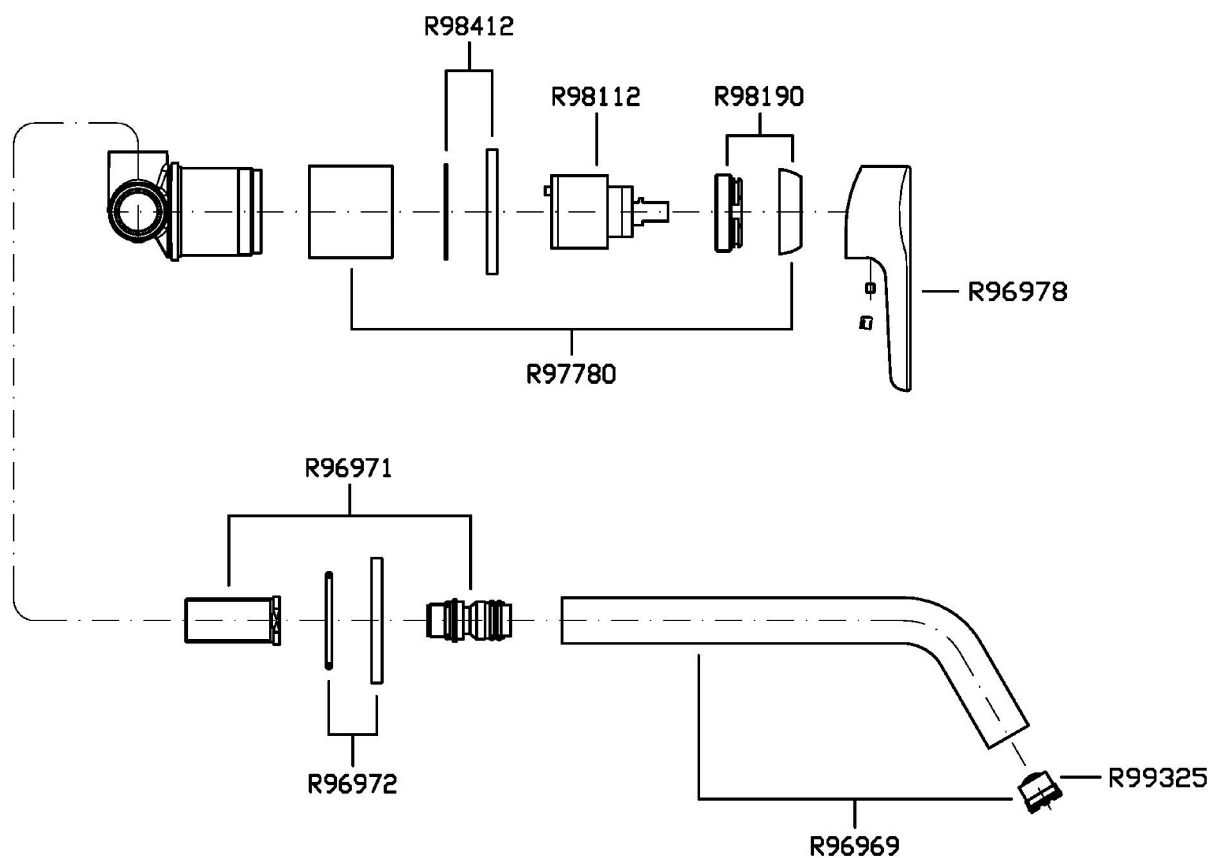

## MEDAMEDA

### ZMM678 Portate / Flowrates (lt/min)

PRESSIONE PRESSURE	1 BAR	2 BAR	3 BAR	4 BAR	5 BAR
P1 LAVABO BASIN	2,9	3,8	4,2	4,3	4,5
P2					
P3					
P4					
P5					

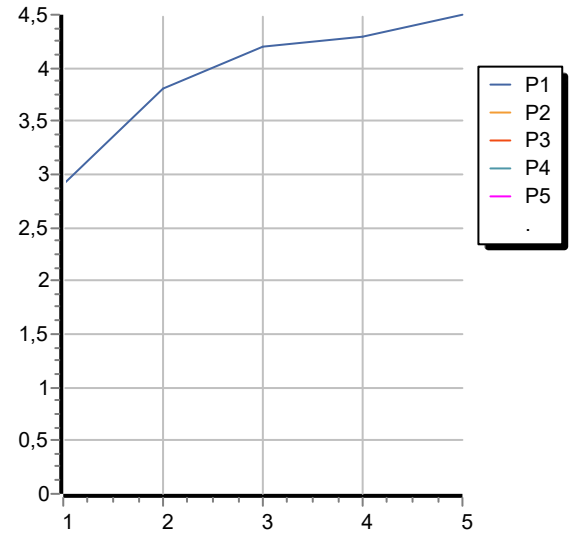

## MEDAMEDA

### ZMM678 Pesì e Misure / Weights and Sizes

Peso ( Kg ) Weight ( lb )	1,05 ( Kg )	2,31 ( lb )
Volume test ( dc3 ) - ( in3 )	3,32 ( dc3 )	202,60 ( in3 )
h ( mm ) - ( in )	93,00 ( mm )	3,66 ( in )
L1 ( mm ) - ( in )	162,00 ( mm )	6,38 ( in )
L2 ( mm ) - ( in )	220,00 ( mm )	8,66 ( in )

