

Marchio / Brand ZUCCHETTI

Classe / Class

PAN

## PAN

ZP6124

Miscelatore monocomando lavabo incasso a 2 fori. / 2 hole built-in single lever basin mixer.



Miscelatore monocomando lavabo incasso con aeratore. Bocca 230 mm.

2 hole built-in single lever basin mixer with aerator. Spout projection 230 mm.









R99815



Parte incasso. / Built-in part.

Altre Finiture / Other Finishes : C3, N1, N7, W1

### Finiture / Finishes

|  |   |   |   |   |   |   |
|--|---|---|---|---|---|---|
|  |  |  |  |  |  |  |
| Cromo / Chrome   | Nickel Spazzolato /<br>Brushed Nickel   | Nickel Lucido / Polished<br>Nickel  | Oro / Gold  | Oro spazzolato / Brushed<br>Gold  | Metal Black / Metal Black   | Metal Black spazzolato /<br>Brushed Metal Black                                       |
|  |  |  |   |   |   |   |
| Bianco Opaco Goffrato /<br>Embossed Matt White                                     | Nero Opaco Goffrato /<br>Embossed Matt Black  | Nero Soft Touch / Soft<br>Touch Black   |   |   |   |   |

## PAN

ZP6124

Disegno Complessivo / Overall Drawing

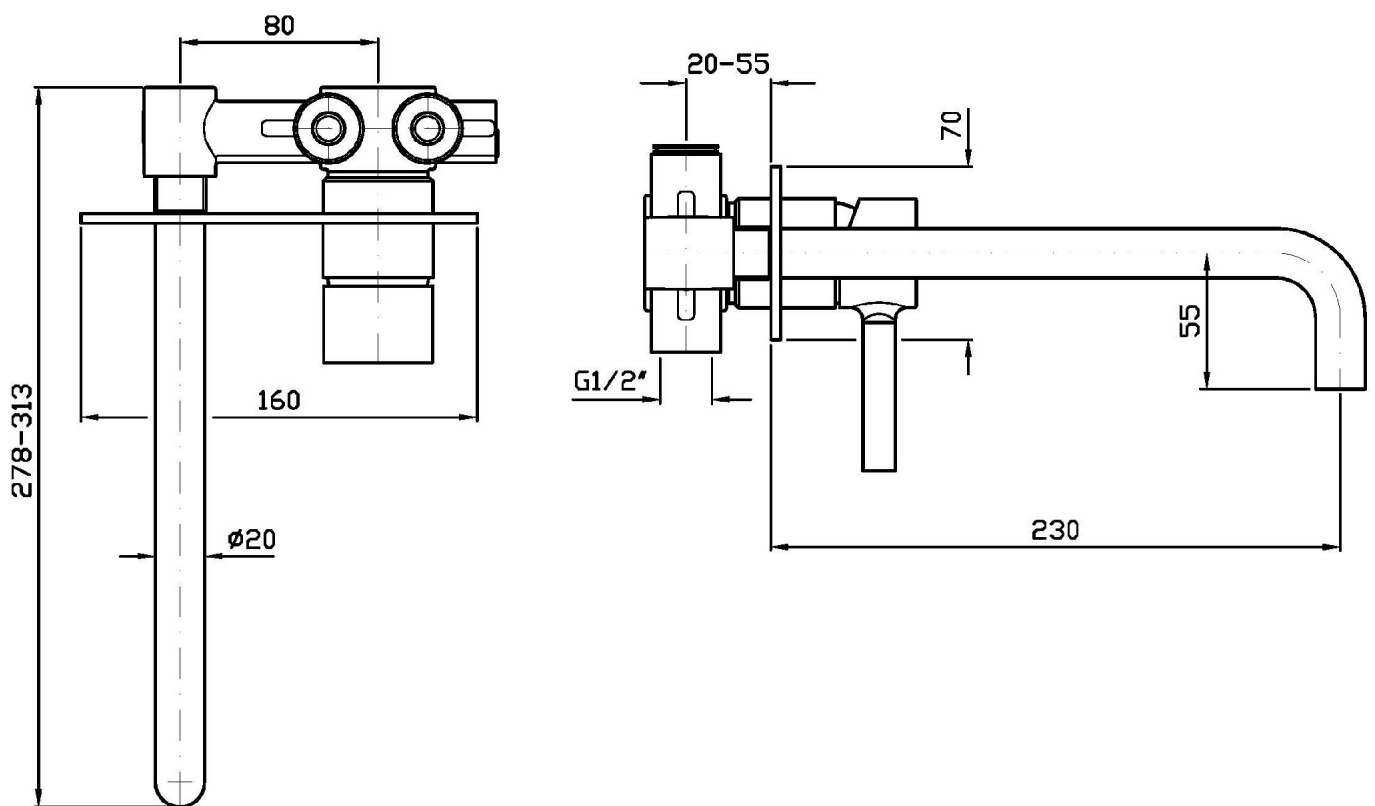

## PAN

ZP6124

Esplosi / Exploded

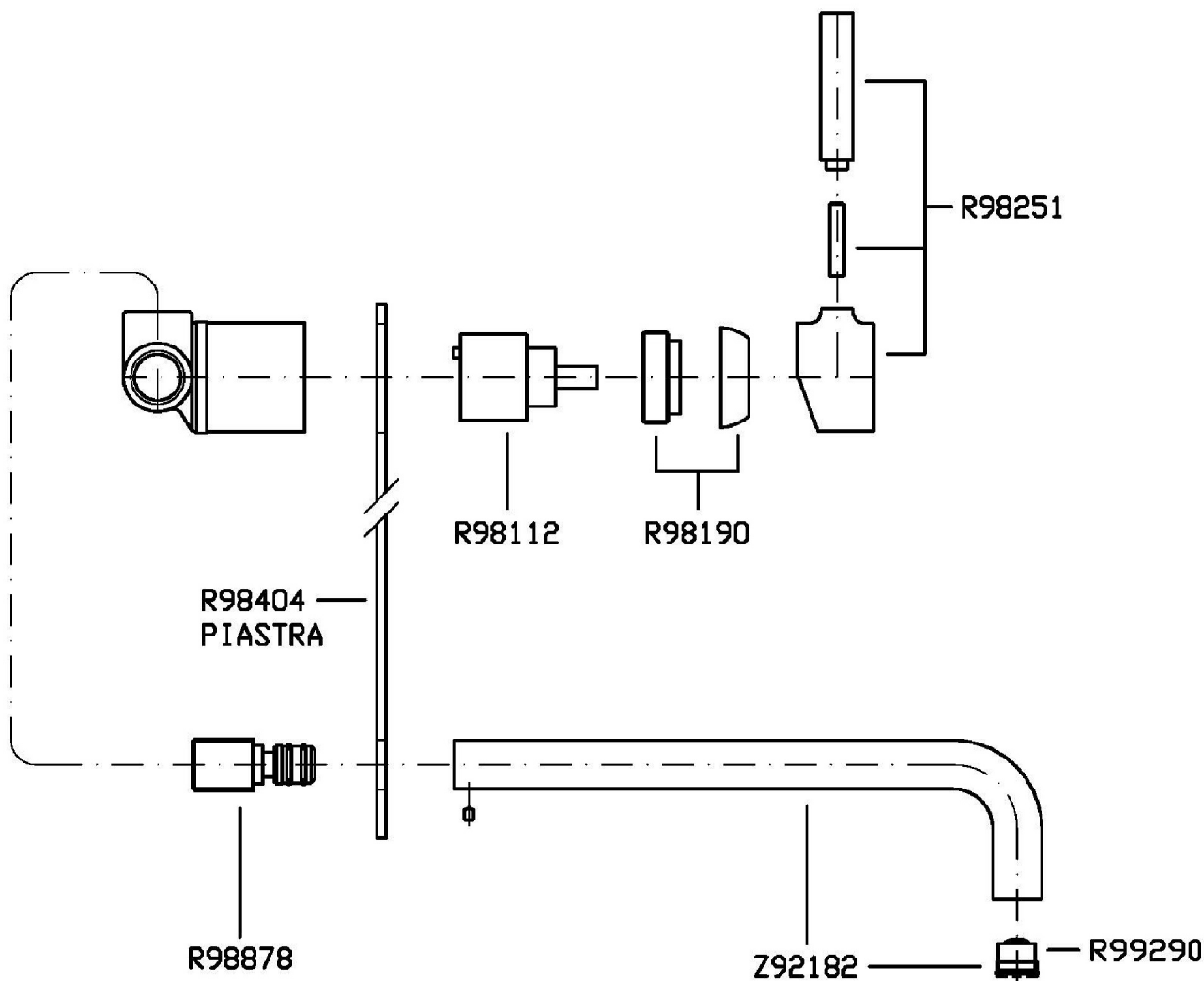

## PAN

### ZP6124 Portate / Flowrates (lt/min)

| PRESSIONE<br>PRESSURE | 1 BAR | 2 BAR | 3 BAR | 4 BAR | 5 BAR |
|-----------------------|-------|-------|-------|-------|-------|
| LAVABO<br>BASIN       | 7,2   | 10,3  | 12,5  | 14,3  | 16    |
| P1                    |       |       |       |       |       |
| P2                    |       |       |       |       |       |
| P3                    |       |       |       |       |       |
| P4                    |       |       |       |       |       |
| P5                    |       |       |       |       |       |

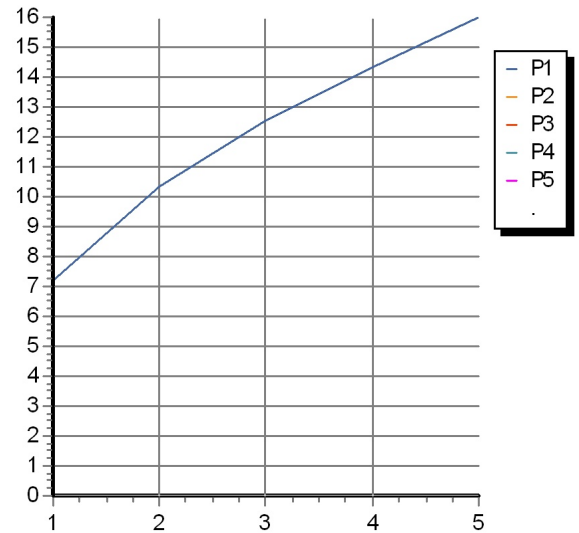

## PAN

### ZP6124 Pesì e Misure / Weights and Sizes

|                           |              |                  |
|---------------------------|--------------|------------------|
| Peso ( Kg ) Weight ( lb ) | 0,971 ( Kg ) | 2,1406666 ( lb ) |
| Volume ( dc3 ) - ( in3 )  | 3,32 ( dc3 ) | 0,000203 ( in3 ) |
| h ( mm ) - ( in )         | 93 ( mm )    | 3,6614193 ( in ) |
| L1 ( mm ) - ( in )        | 162 ( mm )   | 6,3779562 ( in ) |
| L2 ( mm ) - ( in )        | 220 ( mm )   | 8,661422 ( in )  |

